

**-ADDENDUM NUMBER 2**

**May 2, 2023**

---

**PROJECT:  
CITY OF MOBILE PARK IMPROVEMENTS**

**GMC PROJECT NO. AMOB220095**

---

**AD2-1 CLARIFICATIONS / RFI RESPONSES / ADDITIONS / ETC.:**

**AZALEA**

- A. Bidders shall acknowledge receipt of the Addendum in writing, as provided on the Acknowledgment Receipt.
- B. Bids shall be due on May 24, 2023.
- C. The contractor will need to move the existing ball washer from the existing range house that will be demo'd. The contractor will need to store ball washer possibly off site and then the contractor will need to move and reinstall existing ball washer in new range house.

**BAUMHAUER**

- A. Bidders shall acknowledge receipt of the Addendum in writing, as provided on the Acknowledgement receipt.
- B. Bids shall be due on May 31, 2023.

**HOPE**

- A. Bidders shall acknowledge receipt of the Addendum in writing, as provided on the Acknowledgement receipt.
- B. Bids shall be due on May 17, 2023.
- C. The interior lighting is no longer part of this project, except for the gym lights, and the exit lights, they will be part of the project. The exterior lights are still part of the project. See electrical drawings attached.
- D. See clouded revisions on sheet C-A8.01 in regards to which rooms get painted.
- E. Renovate one restroom at a time and keep one restroom fully functional and open while the other restroom is under construction.

**TAYLOR**

- A. Bidders shall acknowledge receipt of the Addendum in writing, as provided on the Acknowledgement receipt.
- B. Bids shall be due on June 7, 2023.

**AD2-2 ISSUED DRAWINGS:**

**BAUMHAUER**

1. Added CB416 Cabinet Details to Addendum #2 for Baumhauer splash pad equipment.

**HOPE**

2. Replace C-A8.01 with revised sheet (Addendum #2) C-A8.01 in its entirety.
3. Replace C-E0.01 Electrical Legend & Abbreviations with revised sheet (Addendum #2) C-E0.01 in its entirety.
4. Replace C-E0.02 Electrical Specifications and Notes with revised sheet (Addendum #2) C-E0.02 in its entirety.
5. Replace C-E1.11 Community Center Lighting Plan- Demolition with revised sheet (Addendum #2) C-E1.11 in its entirety.
6. Replace C-E2.11 Community Center Lighting Plan- New Work with revised sheet (Addendum #2) C-E2.11 in its entirety.

**AD2-3 ISSUED PROJCT MANUAL:**

**HOPE**

7. Replace Hope Community Center Project Manual in its entirety.

**AD2-4 ATTACHMENTS:**

- A. Addendum Acknowledgment Response for Addendum #1 and #2.
- B. Pre-Bid Meeting Agenda and Sign-In Sheet.
- C. Pre-Bid Meeting Minutes.
- D. See drawings listed above.
- E. Electrical Com-Check for Hope Community Center.
- F. Hope Community Center Project Manual.

**END OF ADDENDUM**

PREPARED BY

Sarah M. Downs

Goodwyn Mills Cawood  
11 North Water Street  
Suite 15250  
Mobile, Alabama 36602  
T 251.460.4006  
F 251.460.4223





Goodwyn Mills Cawood  
11 North Water Street  
Suite 15250  
Mobile, Alabama 36602  
T 251.460.4006  
F 251.460.4423

## FASCIMILE TRANSMITTAL COVER SHEET

**DATE:** May 2, 2023

**TO:** Doris Howard

**FROM:** Planholder

**PROJECT:** Parks Improvements  
Azalea City Golf Course, Baumhauer-Randle Park, Hope Community Center, and Taylor Park  
For CITY OF MOBILE  
GMC PROJECT NO. AMOB220095

**RE:** ADDENDUM NO. 1 AND ACKNOWLEDGEMENT OF RECEIPT OF ADDENDUM NO. 1

---

### ACKNOWLEDGEMENT OF RECEIPT:

PLEASE PRINT RECIPIENT'S NAME, FIRM, AND DATE RECEIVED.

THEN FAX BACK TO (251) 460-4423 or EMAIL [doris.howard@gmcnetwork.com](mailto:doris.howard@gmcnetwork.com)  
FOR OUR RECORDS AND TO ACKNOWLEDGE YOUR RECEIPT OF THIS ADDENDUM.

NAME (PLEASE PRINT)

FIRM (PLEASE PRINT)

DATE RECEIVED (PLEASE PRINT)



Goodwyn Mills Cawood  
11 North Water Street  
Suite 15250  
Mobile, Alabama 36602  
T 251.460.4006  
F 251.460.4423

## FASCIMILE TRANSMITTAL COVER SHEET

**DATE:** May 2, 2023

**TO:** Doris Howard

**FROM:** Planholder

**PROJECT:** Parks Improvements  
Azalea City Golf Course, Baumhauer-Randle Park, Hope Community Center, and Taylor Park  
For CITY OF MOBILE  
GMC PROJECT NO. AMOB220095

**RE:** ADDENDUM NO. 2 AND ACKNOWLEDGEMENT OF RECEIPT OF ADDENDUM NO. 2

---

### ACKNOWLEDGEMENT OF RECEIPT:

PLEASE PRINT RECIPIENT'S NAME, FIRM, AND DATE RECEIVED.

THEN FAX BACK TO (251) 460-4423 or EMAIL [doris.howard@gmcnetwork.com](mailto:doris.howard@gmcnetwork.com)  
FOR OUR RECORDS AND TO ACKNOWLEDGE YOUR RECEIPT OF THIS ADDENDUM.

NAME (PLEASE PRINT)

FIRM (PLEASE PRINT)

DATE RECEIVED (PLEASE PRINT)

**PRE-BID CONFERENCE AGENDA  
PROJECT  
FOR  
CITY OF MOBILE PARK IMPROVEMENTS  
AE CONFERENCE ROOM  
GMC PROJECT NO. AMOB220095  
April 26, 2023 at 9:00 a.m.**

Note: *This Agenda is complimentary, for general use as an outline and for discussion during this meeting. Any errors, omissions, or clarifications shall be communicated to the Architect for distribution. This Agenda does not attempt to be, nor represent, any recapitulation of Project requirements, and does not change or alter same in any respect; Changes, if any, will only be made by written Addendum.*

1. Welcoming remarks. Reminder to sign in on sheet being circulated

2. Name of Owner – City of Mobile  
Project Manager –Shannon McIntyre

Goodwyn, Mills & Cawood Architect personnel:  
Jim Walker - Project Architect  
Sarah Downs – Interior Designer  
Doris Furr – Administrative Assistant

3. Every General Contractor and every Subcontractor should read and be familiar with all of the “front-end” documents and all of Division 1 of the Project Manual, in addition to the work they are bidding and have to coordinate with.

4. **Bid time, date, place** – are indicated in the Advertisement for Bids; Sealed bids will be received and clocked in until 2:15 pm, Wednesday, the 17<sup>th</sup> day of May, 2023 ; bidders shall insert sealed Bids into a receptacle, marked “City of Mobile Bids”, located in the elevator lobby outside the office of the City Clerk Office, 9<sup>th</sup> Floor South Tower, Government Plaza, 205 Government Street, Mobile, Alabama 36602. Bid will be publicly opened and read at 2:30 PM local time, in the Atrium Lobby of Government Plaza.

**It is the Contractors responsibility to make sure Bid is received prior to bid time or they will not be accepted.**

5. Note that Advertisement and Instructions to Bidders should be read by each bidder. For insurance requirements refer to Invitation & Instructions to Bidders in the Project Manual. A Certificate of Insurance evidencing all the minimum requirements must be provided to and accepted by the City of Mobile prior to commencing on the contract.

6. Contractors shall use the Bid Form included in Project Manual, copies of which are furnished to each bidder with Bid Documents. Bids must include Attachment A to Bid Form (Unit Prices) at Bid time

and date.

7. Before submitting a bid for the Work, the bidders shall carefully examine the Bid Documents, visit the site, and satisfy themselves as to the nature and location of the Work, and the general and local conditions, including weather, the general character of the site and building, the character and extent of existing work within or adjacent to the site and any other work being performed thereon at the time of submission of their bids.
8. Addenda - Minutes of Pre-Bid Meeting, and any pertinent items discussed shall be issued as Addendum following the Pre-Bid Meeting. Any further addenda necessary after the Pre-Bid Meeting will be issued to all plan holders.
9. Clarification will be made only by written Addenda posted on the City of Mobile website. Questions and Clarifications must be submitted in writing 48 hours prior to bid.
10. When the Bid Documents identify three or more sources and the list of sources is not followed by "or approved equal" or similar wording, the bidder's proposal shall be based upon one of the identified sources, unless the bidder obtains "Pre-bid Approval" of another source. Approval of substitutions, if granted, shall not be effective until published by the Architect in an addendum to the Bid Documents. Requests for substitutions will not be considered 72 hours prior to bid.
11. If there is a conflict, discrepancy, or confusion between the existing conditions, plans and specifications for work, materials or equipment and the Contractor does not receive written clarification from the Architect prior to the opening of bids the Contractor shall include the better quality or greater quantity of work in his/her bid.
12. Bids must be submitted on the Bid Form as contained in the Bid Documents; only one copy is required to be submitted.
13. All information requested of the bidder on the Bid Form must be filled in. The form must be completed by typewriter or hand-printed in ink.
14. Bids shall be accompanied by a Bid Security equal to 5% (percent) of the total bid price, including the allowance if any, but in no event not more than \$10,000.00. Bid Security shall be on the form of a Bid Bond or cashier's check payable to the City of Mobile. No Bid Security is required on Bids less than \$10,000.00.
15. Bid, with Bid Security, Sales Tax Form C-3A, City of Mobile Subcontracting and Major Supplier Plan and other supporting data specified, shall be contained in a sealed, opaque envelope, approximately 9x12 inches or larger and be marked on the outside with the words "SEALED BID FOR (PROJECT NAME) – PROJECT NUMBER: (PR-XXX-XX)".
16. Performance Assurance and Insurance: The bidder to whom award is made shall provide a Performance Bond equal to 100% of the total Contract Amount (including the allowance) and a Labor and Material Bond equal to 100% of the total contract amount (including the allowance). The accepted Bidder shall also provide insurance as required in section 1.20

**NO WORK IS TO BE PERFORMED UNTIL PROOF OF COMPLIANCE WITH THE INSURANCE REQUIREMENTS HAS BEEN RECEIVED BY THE CITY OF MOBILE.**

17. A valid City of Mobile business license for the duration of the contract period. E-verify Documentation: The Beason-Hammond Taxpayer Protection Act applies to this project. Contractor shall comply with the requirements of this Act and show proof of enrollment in the E-verify program by submitting the electronically generated Federal E-verify document prior to signing of the construction contract. (see Project Manual)
18. Bids may be delivered in person or by mail if ample time is allowed for delivery.
19. Bids will be opened and read publicly at the time and place indicated in the Advertisement for Bids.
20. Alternates, if any, are listed in the Bid Form in the order in which they shall cumulatively add to from the base bid for determining the lowest bidder.
21. Award of contract by Awarding Authority, ASAP after the opening of bids.
22. Proposals may be rejected if they contain any omissions, alterations of forms, additions not called for, conditional bids, alternate bids unless called for, incomplete bids, erasures, or irregularities of any kind.
23. Completion Time for Project: Base Bid Completion Time: **varies for each project, see Project Manuals.** Time begins from date of Official Notice to Proceed
24. At the time the Contractor duly awarded the Bid receives the signed Contract and the Notice to Proceed, he shall submit a Schedule of Work Progress to the Architect which reasonably reflects the amount of time required for each Phase of Work and the deadline by which it can be expected that such phase of the Work shall be completed. This Schedule should accurately reflect the date for Substantial Completion, and take into consideration any reasonable contingencies.
25. The Contractor shall be responsible for all project safety. Neither the Architect nor the Owner will be responsible for the Contractor's safety precautions, means, methods, techniques, sequences, or procedures. Contractor's personnel responsible for safety shall be OSHA certified. Safety barricades (as described in the contract documents) for project, including equipment and storage areas, part of contractors means, methods, techniques, sequences, procedures; cost of any type fencing, barricades, etc. necessary shall be incidental to project.
26. Parking for Contractors and their Subs and workers: Shall be coordinated with the Owner.
27. Traffic Control:
  - Coordinate all construction activities with parties having jurisdiction.
  - Particular attention shall also be paid to vehicular and pedestrian traffic and routing of such during project.

- 28.** Meetings: Owner / Architect / Contractor (OAC) Progress Meeting to be held per project requirements.  
Pre-Construction Conference will be held once a Contractor has been awarded the project and contract signed.
- 29.** Liquidated Damages: Per Item II Invitation & Instructions to Bidders, 1.24 LIQUIDATED DAMAGES: for non-completion of the work within the time limited agreed upon will be assessed in the amount of actual damages to the Owner but in no event not more than \$250.00 per day.
- 30.** Retainage withheld at 5% of the first 50% of Construction Completed until the amount equals 2.5% of the full contract amount. The final 2.5% of the full contract amount is withheld as retainage until all close out requirements are met, proof of advertisement, warranties, Consent of Surety and release of liens, etc. By State of Alabama Law, notice of final completion of the contract shall be published in a local newspaper of general circulation.
- 31.** Goodwyn Mills & Cawood, Inc. (Project Architect). Address and telephone numbers: 11 North Water Street, Suite 15250, Battle House Tower, Mobile, AL 36602, Phone: (251) 460-4006, Fax (251) 460-4423.  
Project Manager: Jim Walker, AIA  
Email: [jim.walker@gmcnetwork.com](mailto:jim.walker@gmcnetwork.com)  
[sarah.downs@gmcnetwork.com](mailto:sarah.downs@gmcnetwork.com)  
[doris.howard@gmcnetwork.com](mailto:doris.howard@gmcnetwork.com)
- 32.** Closing remarks / questions.





Goodwyn Mills Cawood

**CITY OF MOBILE  
PARK IMPROVEMENTS  
PRE-BID MEETING SIGN-IN SHEET  
April 26, 2023 at 9:00 a.m.**

NAME	COMPANY	PHONE	EMAIL
Nathan Hawk	Harrison Construction	251-769-2719	jedge@harrison-const.com
Jeremy Wheeler	Kellim Contracting	251-509-5540	jwheeler@KellimContracting.com
Chris Dunning	Youngblood-Berrett Const & Eng.	251-295-0745	chris.dunning@ybce.net
<b>JIM WALKER</b>	<b>GMC</b>	<b>251-461-4004</b>	<b>JIM.WALKER@GMCNETWORK.COM</b>
<b>Shannon McIntyre</b>	<b>COM</b>	<b>251-508-7752</b>	<b>shannon.mcintyre@cityofmobile.org</b>
Jason Carter	Integrity Maintenance	251-391-9073	integritym.17@gmail.com
<b>Sarah M. Downs</b>	<b>GMC</b>	<b>205-427-0810</b>	<b>sarah.downs@gmcnetwork.com</b>
John Aecker	Aecker Construction	251-259-7995	aeckerconstruction@gmail.com
Leah Dees	Rogers & Willard	251-644-4330	LDEES@RogersWillard.com
Ken Williams	City of Mobile	251-358-1412	Ken.Williams@CityofMobile.org
Roger Cook	City of Mobile - OSD	251-208-7632	roger.cook@cityofmobile.org
Lott Brigham	BAC	251-377-5644	lhbbrigham1@gmail.com
<b>Brian Harris</b>	<b>Harris Contracting</b>	<b>251-377-3137</b>	<b>Brian@harriscontractingservices.com</b>



May 1, 2023

**Goodwyn Mills Cawood**

11 North Water Street  
Suite 15250  
Mobile, AL 36602

T (251) 460-4006  
F (251) 460-4423

www.gmcnetwork.com

**RE: City of Mobile- 4 Parks-  
Meeting Minutes**

**PROJECT NO:** COM Project No. PR-029-21, PR-092-21, PR-090-21, PR-091-21  
GMC Project No. AMOB220095

**ATTENDEES:** Nathan Hawk – Harrison Construction  
Shannon McIntyre- City of Mobile- Project Manager  
Jim Walker- GMC- Project Architect  
Sarah Downs- GMC-RID/ Assist Project Manager  
Jeremy Wheeler – Rellim Contracting  
Chris Dunning – Youngblood-Barrett Const. & Eng.  
Jason Carter – Integrity Maintenance  
John Aeiker – Aeiker Construction  
Leah Dees – Rogers and Willard  
Ken Williams, Roger C. – City of Mobile  
Lott Brigham – BAC  
Brian Harris – Harris Contracting

**On Call:** John Kilpatrick, Avalisha Fisher, Christy Marie

NO.	ITEMS DISCUSSED:	ACTION:
1.	Meeting Date: April 26, 2023; Time: 9:00a.m.; Location: Government Plaza- 5 <sup>th</sup> floor Conference Room	
2.	<b>Taylor Park:</b>	
3.	Bid will be due June 7 <sup>th</sup> (this park will bid 4 <sup>th</sup> )	
4.	Bleacher concrete pad will be in phase 3.	
5.	The swell is in Phase 1.	
6.	The stairs will be in base bid. Phase 1.	
7.	No alternates	
8.	The pool will need to be open Memorial Day weekend.	
9.	Then the city will empty pool and be ready for construction.	
10.	<b>Azalea City Golf Course:</b>	
11.	Bid will be due May 24 <sup>th</sup> (this park will bid 2 <sup>nd</sup> )	
12.	The existing ball washer will need to be moved from range house that will be demo'd by the contractor, contractor will need to store ball washer possibly off site, and then contractor will need to reinstall ball washer into new range house.	
13.	<b>Baumhauer- Randle Park:</b>	
14.	Bid will be due May 31 (this park will bid 3 <sup>rd</sup> )	
15.	Sarah will find out if there will be any tap fees or pay separately. Who pays for tap fees?	GMC
16.	<b>Hope Community Center:</b>	
17.	Bid will be due May 17 (this park will bid 1 <sup>st</sup> )	
18.	Gym lighting – in project.	
19.	The electrical has changed. We will issue this in the addendum. The interior lights have been replaced recently and only the exterior lights, gym lights, and the exit lights will be replaced in this bid.	GMC
20.	New partitions in restroom.	



21.	Adjust note for restroom. "Renovation one restroom at a time and keep one restroom open for use while the other restroom is under construction."	GMC
22.	<b>General Notes:</b>	
23.	Not mandatory to be attend the pre-bid meeting.	
24.	Contractors can go to site @ a later date before bids are due.	
25.	We will stagger bids 1 week apart : Hope Community Center- May 17 <sup>th</sup> Azalea City Golf Course- May 24 <sup>th</sup> Baumhauer-Randle Park- May31st Taylor Park- June 7th	
26.	Shannon will put Addenda on website <a href="http://www.cityofmobile.org">www.cityofmobile.org</a> Go to Bids/Real Estate Management/Bids then find the park to bid on.	
27.	Fill out bid form – contractor will acknowledge Qty of Addendum's acknowledged on the bid form.	
28.	Contractor asked if there are any required classifications? Shannon says that the contractor can call Andy Earle with the state to see if they qualify.	
29.	4 separate projects – 4 separate bids – 4 separate envelopes.	
30.	Base bid + cumulative alternates – lowest with the most alternates selected.	
31.	If there are any questions email Jim Walker, Sarah Downs, Doris Howard Furr and copy Shannon McIntyre.	

**BY: Sarah M. Downs, RID**

**CC:** Shannon McIntyre- City of Mobile  
Jim Walker- GMC

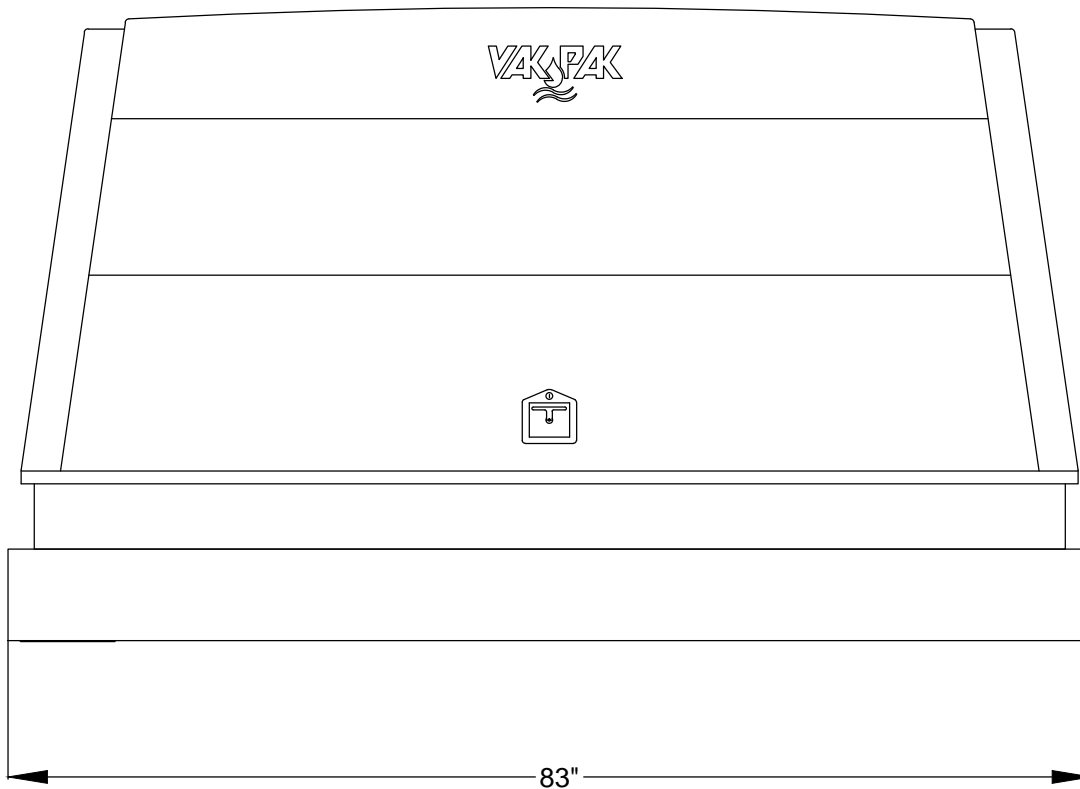

FRONT VIEW

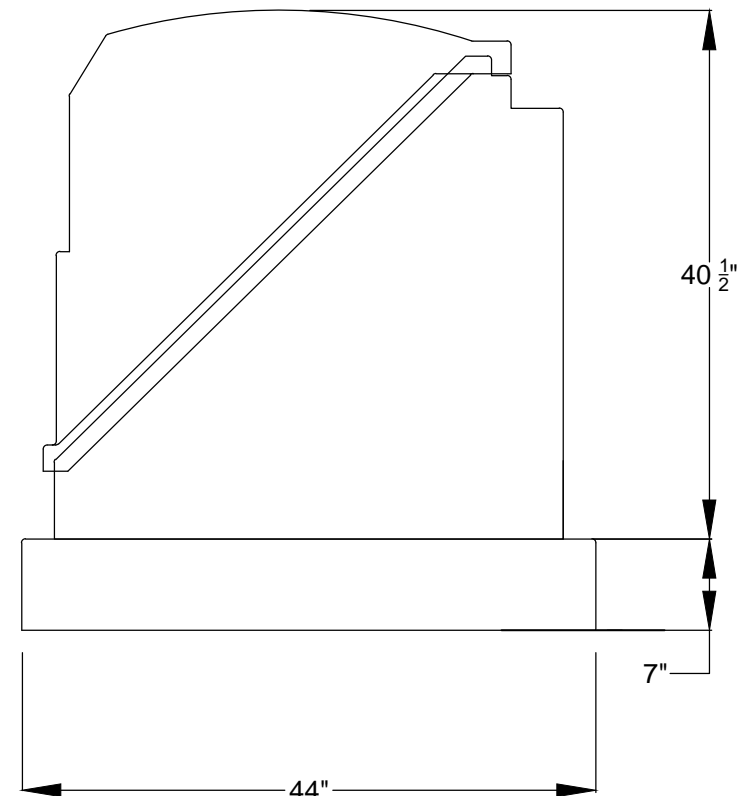

SIDE VIEW

## VAK PAK CB416 SERIES CABINET DETAILS



P.O BOX 3264 - JACKSONVILLE, FL 32206  
(904)353-4403

THIS SPACE RESERVED FOR STATE APPROVAL STAMP

DRAWN BY:  
**EM**

DRAWN DATE:  
**05/16/18**

MODEL #  
**CB416**

REVISED BY:

REVISED DATE:

SCALE  
**1:1**

REVISIONS

RECORD #

SHEET  
**1 of 1**

AS OF DATE:

CB416  
CABINET DETAILS



WRAP COUNTER W/ STAINLESS STEEL. REPAIR CABINETS AND REPLACE HARDWARE

MEETING ROOM 2 106 600 SF  
PT-1  
EXT-1  
EXT-1

NEW CABINET

VENDING 105 31 SF

LOBBY 101 568 SF  
PT-1/5  
EXT-1  
EXT-1

NEW RECEPTION DESK

OFFICE 111 130 SF  
EXT-1  
EXT-1  
EXT-1

CLO. 4 116 16 SF

CLO. 3 112 15 SF

ART ROOM 113 171 SF  
PT-1  
EXT-1  
EXT-1

JAN. 1 122 22 SF

MECH. 1 152 SF  
PT-1  
EXT-1  
EXT-1

BLDG. MAINT. 124 111 SF  
PT-1  
EXT-1  
EXT-1

NEW CABINET

COMPUTER ROOM 125 390 SF  
PT-1  
EXT-1  
EXT-1

PT-4

NEW GAME CONSOLE CABINET

GAMER ROOM 102 1010 SF  
EXT-1  
EXT-1  
EXT-1

PT-4

NEW GAME CONSOLE CABINET

PROVIDE WALK-OFF MATS

NEW WALL PANEL

TP-1

WOMEN 113 187 SF  
EX  
HST-1  
HFT-1

MEN 114 187 SF  
EX  
HST-1  
HFT-1

KITCHEN 121 161 SF  
PT-1  
EXT-1  
EXT-1

PT-1

OW-1

CLO. 6 119 7 SF

PT-4

MULTI-PURPOSE RM 1 117 754 SF  
EX  
EXT-1  
EXT-1

MULTI-PURPOSE RM 2 118 751 SF  
EX  
EXT-1  
EXT-1

CORR. 110 497 SF  
PT-1/5  
EXT-1  
EXT-1

PT-1

NEW WALL PANEL FOR TV CABINET

CLO. 7 120 29 SF

PAINT CORRIDOR PT-5 FROM FLOOR UP TO 5'-0" PT-1 FROM 5'-0" UP TO CEILING

PROVIDE WALK-OFF MAT

CAT-1

	<p>PLANS FOR FLOOR PATTERNS. CONTRACTOR TO NOTIFY INTERIOR DESIGNER BEFORE INSTALLATION OF FLOORING TO REVIEW DESIGN INTENT OF FLOOR PATTERN PLAN.</p> <p>REFER TO RCP FOR ACCENT PAINT COLOR LOCATIONS.</p> <p>WHERE HARD FLOOR TILE IS USED, CENTER PATTERN IN ROOM. ALIGN VERTICAL GROUT LINES OF WALL TILE THOSE IN FLOOR TILE.</p> <p>GROUT COLORS TO BE DETERMINED DURING CONSTRUCTION.</p> <p>INSTALL 3MM EDGE BAND ON ALL PLASTIC LAMINATE COUNTERTOPS TO MATCH COUNTERTOP LAMINATE COLOR. GC TO ALLOW ADEQUATE TIME FOR SPECIAL PRODUCTION RUN.</p> <p>ALL ACCESS PANELS AND GRILLES TO BE PAINTED WALL OR CEILING COLOR, UNLESS OTHERWISE NOTED.</p>
--	--

FLOOR FINISH LEGEND

	HFT-1
---	-------

## FINISH PLAN &

HOPE COMMUNITY CENT  
350 EDWARDS STREET  
MOBILE, ALABAMA 36610  
GMC # AMOB220095  
COM # PR-090-21

HOPE COMMUNITY CENTER IMPROVEMENTS  
350 EDWARDS STREET  
MOBILE, ALABAMA 36610  
GMC # AMOB220095  
COM # PR-090-21

1	ADDENDUM 2	05/02/2023
2		
3		
4		
5		
6		
7		
8		
9		
10		
11		
12		
13		
14		
15		
16		
17		
18		
19		
20		
21		
22		
23		
24		
25		
26		
27		
28		
29		
30		
31		
32		
33		
34		
35		
36		
37		
38		
39		
40		
41		
42		
43		
44		
45		
46		
47		
48		
49		
50		
51		
52		
53		
54		
55		
56		
57		
58		
59		
60		
61		
62		
63		
64		
65		
66		
67		
68		
69		
70		
71		
72		
73		
74		
75		
76		
77		
78		
79		
80		
81		
82		
83		
84		
85		
86		
87		
88		
89		
90		
91		
92		
93		
94		
95		
96		
97		
98		
99		
100		
101		
102		
103		
104		
105		
106		
107		
108		
109		
110		
111		
112		
113		
114		
115		
116		
117		
118		
119		
120		
121		
122		
123		
124		
125		
126		
127		
128		
129		
130		
131		
132		
133		
134		
135		
136		
137		
138		
139		
140		
141		
142		
143		
144		
145		
146		
147		
148		
149		
150		
151		
152		
153		
154		
155		
156		
157		
158		
159		
160		
161		

11 North Water Street, Suite 15250  
Mobile, AL 36602  
T 251.460.4006  
GMCNETWORK.COM

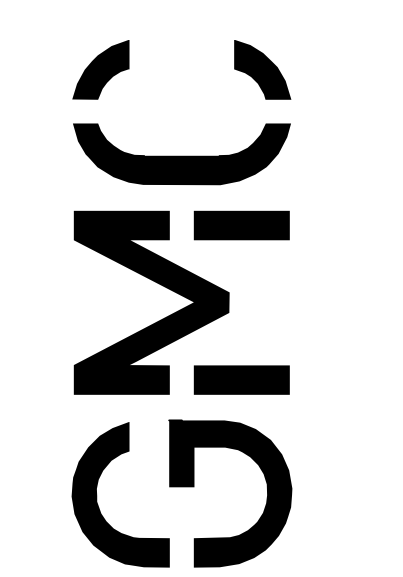



## ABBREVIATIONS

OTHER:

- CIRCUIT RUN CONCEALED ABOVE CEILING OR IN WALL.
- - - CIRCUIT RUN CONCEALED IN OR BELOW FLOOR SLAB OR UNDERGROUND.

2P2-9

HOMERUN TO PANELBOARD, ANY CIRCUIT WITHOUT FURTHER DESIGNATION SHALL BE #212 3/4". TICK MARKS INDICATE # OF CONDUCTORS (EGC NOT INCLUDED), MINIMUM SIZE ON 120V HOMERUNS GREATER THAN 50 FEET SHALL BE #10 AWG, MINIMUM SIZE ON 120V HOMERUNS GREATER THAN 100 FEET SHALL BE #8 AWG, MINIMUM SIZE ON 277V HOMERUNS GREATER THAN 100 FEET SHALL BE #10 AWG, INCREASE CONDUIT SIZE AS REQUIRED PER NEC. UNDERLINED TEXT INDICATES CIRCUIT DESIGNATION.



➤ LIGHT FIXTURE IDENTIFICATION TAG. SEE LIGHT FIXTURE SCHEDULE FOR SYMBOLS & DETAILS.



5) PANELBOARD, SWITCHBOARD, TRANSFORMER & ELECTRICAL EQUIPMENT IDENTIFICATION TAG.



LEADERS.

MARK	MANUFACTURER	LAMP TYPE	WATTS	TOTAL WATTS	MOUNTING	NOTES
EMEX	LITHONIA LIGHTING LHQM LED R HO SD	LED	12 W	12 W	WALL OR CEILING AS INDICATED	LED EMERGENCY EGRESS / EXIT COMBINATION FIXTURE - PROVIDE WITH INTEGRAL BATTERY BACK UP
HB	LITHONIA - IBG-30000LM-SEF-LJLNS-WD-208V-GZ10-40K-80C RI-NLTAIR2RLXSR6-WGIBG26	LED	178 W	178 W	EXISTING SUPPORT	DIMMABLE LED HIGH BAY FIXTURE WITH WIRELESS CONTROLLER - PROVIDE AND INSTALL REQUIRED SAFETY CHAIN IN ADDITION TO EXISTING SUPPORTS - SECURE TO STRUCTURE - PROVIDE EMERGENCY BATTERY BACK UP AS INDICATED ON THE PLANS
ST	SOLERA LLA-48WLED-7357-4000K-UNV-RTC-LPL-FT-SD-MS- TP-TS-BZ	LED	48 W	48 W	RECESSED	LED STEP LIGHT FIXTURE
EVO	GOTHAM EVO8 35/20 AR WD TRW GVRT	LED	31.6 W	32 W	RECESSED GRID OR FLANGE	8" WET LOCATION LISTED DIMMABLE LED DOWNLIGHT - PROVIDE WITH INTEGRAL BATTERY BACK UP AS SHOWN ON PLAN
WPX	LITHONIA WPX1 LED P2 40K MVOLT DDBXD	LED	24 W	24 W	WALL	UL LISTED FOR WET LOCATIONS, LED WALL PACK - PROVIDE WITH INTEGRAL BATTERY BACK UP AS SHOWN ON PLAN - MOUNTING HEIGHT TO MATCH EXISTING FIXTURE MOUNTING HEIGHT UNLESS OTHERWISE NOTED

NOTES: THE ELECTRICAL CONTRACTOR SHALL PROVIDE AND INSTALL ALL MOUNTING HARDWARE AS REQUIRED FOR A NEAT AND COMPLETE INSTALLATION. ALL FIXTURES ARE TO BE APPROVED BY THE OWNER PRIOR TO ORDER. FIXTURES WITH HALF FILLED IN CENTER SHALL BE PROVIDED WITH A BATTERY PACK. SEE PLANS FOR QUANTITY. ALL FIXTURES / POLES TO BE APPROVED BY CITY OF MOBILE PRIOR TO ORDER AND INSTALLATION. PRIOR APPROVALS MUST BE SUBMITTED TO THE ENGINEER 14 DAYS PRIOR TO BID DATE FOR REVIEW.

- |       |  |      |  |
|-------|--|------|--|
| AC    | AMPS                                     | MCM  | THOUSAND CIRCULAR MILS                   |
| ACB   | ABOVE COUNTER                            | MH   | MANHOLE                                  |
| AF    | AMP FRAME                                | MIN  | MINIMUM                                  |
| AFB   | ABOVE FINISH FLOOR                       | MISC | MISCELLANEOUS                            |
| AFG   | ABOVE FINISH GRADE                       | MLO  | MAIN LUGS ONLY                           |
| AHU   | AIR HANDLING UNIT                        | MNT  | MOUNTING HEIGHT                          |
| AI    | ALUMINUM                                 | MTG  | MOUNTING                                 |
| ARCH  | ARCHITECT OR ARCHITECTURAL               | MV   | MEDIUM VOLTAGE                           |
| AT    | AMP TRIP                                 | N1   | NEMA 1                                   |
| ATS   | AUTOMATIC TRANSFER SWITCH                | N3R  | NEMA 3R                                  |
| ATU   | AIR TERMINAL UNIT                        | N/A  | NOT APPLICABLE                           |
| AWG   | AMERICAN WIRE GAUGE                      | NA   | NOT APPLICABLE                           |
| BE    | BUILDING AUTOMATION SYSTEM               | NCE  | NATIONAL ELECTRICAL CODE                 |
| B     | BONDING JUMPER                           | NESC | NATIONAL ELECTRICAL SAFETY CODE          |
| BKR   | CIRCUIT BREAKER                          | NEU  | NEUTRAL                                  |
| BLDG  | BUILDING                                 | OCPD | OVERCURRENT PROTECTION DEVICE            |
| BOD   | BASIS OF DESIGN                          | OFOI | OWNER FURNISHED OWNER INSTALLED          |
| C     | CONDUIT                                  | OFCI | OWNER FURNISHED CONTRACTOR INSTALLED     |
| C/B   | CIRCUIT BREAKER                          | OH   | OVERHEAD                                 |
| CL    | CURRENT LIMITING                         | OHE  | OVERHEAD ELECTRIC                        |
| CLL   | CENTERLINE                               | OHP  | OVERHEAD PRIMARY                         |
| CLG   | CEILING                                  | OHS  | OVERHEAD SECONDARY                       |
| CKT   | CIRCUIT                                  | PBD  | PANELBOARD                               |
| CT    | CURRENT TRANSFORMER                      | PF   | POWER FACTOR                             |
| CU    | COPPER                                   | PNL  | PANELBOARD                               |
| DDC   | DIRECT DIGITAL CONTROL                   | PT   | POTENTIAL TRANSFORMER                    |
| DEMO  | DEMOISH                                  | PWR  | POWER                                    |
| EC    | ELECTRICAL CONTRACTOR                    | RCPT | RECEPTACLE                               |
| EGC   | EQUIPMENT GROUNDING CONDUCTOR            | REQD | REQUIRED                                 |
| ELEC  | ELECTRICAL                               | RM   | ROOM                                     |
| EF    | ENTRANCE FACILITY                        | RGS  | RIGID GALVANIZED STEEL CONDUIT           |
| EGC   | EQUIPMENT GROUNDING CONDUCTOR            | RNC  | RIGID NON-METALLIC CONDUIT               |
| EMGB  | ELECTRIC MAIN GROUNDING BUSBAR           | RVSS | REDUCED VOLTAGE SOLID STATE              |
| EWV   | ELECTRIC WATER COOLER                    | SA   | SURGE ARRESTER                           |
| EX    | EXISTING TO REMAIN                       | SCA  | SHORT CIRCUIT AMPS                       |
| EMT   | ELECTRICAL METALLIC TUBING               | SF   | SUPPLY FAN                               |
| EQUIP | EQUIPMENT                                | SPEC | SPECIFICATION                            |
| FMC   | FLEXIBLE METAL CONDUIT                   | SWBD | SWITCHBOARD                              |
| FACP  | FIRE ALARM SYSTEM CONTROL PANEL          | SWGR | SWITCHGEAR                               |
| FU    | FUSE                                     | TBB  | TELECOMMUNICATIONS BONDING BACKBONE      |
| FA    | FIRE ALARM                               | TB   | TELECOMMUNICATIONS ROOM                  |
| FL    | FULL LOAD AMPS                           | TGB  | TELECOMMUNICATIONS GROUNDING BUSBAR      |
| FLR   | FLOOR                                    | TGBB | TELECOMMUNICATIONS MAIN GROUNDING BUSBAR |
| FVNR  | FULL VOLTAGE NON-REVERSING               | TVSS | TRANSIENT VOLTAGE SURGE SUPPRESSION      |
| GFCI  | GROUND FAULT INTERRUPTER                 | TYP  | TYPICAL                                  |
| G     | GROUND (OR GFI FOR RECEPTACLE SUBSCRIPT) | UFFR | UNDERFLOOR RACEWAY                       |
| GC    | GENERAL CONTRACTOR                       | UG   | UNDERGROUND                              |
| GD    | GROUND                                   | UGE  | UNDERGROUND ELECTRIC                     |
| GEC   | GROUNDING ELECTRODE CONDUCTOR            | UGF  | UNDERGROUND FIBER                        |
| HE    | HANDHOLE                                 | UGS  | UNDERGROUND SECONDARY                    |
| HOA   | HAND-OFF-AUTOMATIC                       | UL   | UNDERWRITERS' LABORATORIES               |
| HP    | HEAT PUMP OR HORSEPOWER                  | UNO  | UNLESS NOTED OTHERWISE                   |
| HVAC  | HEATING, VENTILATION, & AIR-CONDITIONING | UNP  | UNINTERRUPTIBLE POWER SUPPLY             |
| IG    | ISOLATED GROUND                          | V    | VOLT                                     |
| IMC   | INTERMEDIATE METAL CONDUIT               | VA   | VOLT-AMPERES                             |
| J     | JUNCTION BOX                             | VAR  | VOLT-AMPERES REACTIVE                    |
| K     | KILO                                     | VAV  | VARIABLE AIR VOLUME UNIT                 |
| KAIC  | KILO-AMPERE INTERRUPTING CAPABILITY      | W    | WATTS                                    |
| KCMIL | THOUSAND CIRCULAR MILS                   | WP   | WEATHERPROOF                             |
| LCP   | LIGHTING CONTROL PANEL                   | WSR  | WITHSTAND RATING                         |
| LGT   | LIGHTING                                 | WFMR | TRANSFORMER                              |
| LFMC  | LIQUID TIGHT FLEXIBLE METAL CONDUIT      | XP   | EXPLOSION PROOF                          |
| LV    | LOW VOLTAGE                              | Ø    | PHASE                                    |
| MAX   | MAXIMUM                                  | 72°  | DEGREES                                  |
| MCA   | MINIMUM CIRCUIT AMPACITY                 | Δ    | DELTA                                    |
| MCC   | MOTOR CONTROL CENTER                     | Ω    | OHMS                                     |
| MCE   | MAIN COMMUNICATIONS EQUIPMENT ROOM       |      |  |



**GMCNETWORK.COM**

11

GMC # AMOB220095



# C-E0.02

sheet

GENERAL ELECTRICAL:

- 1.1. THE CONTRACTOR SHALL FURNISH ALL LABOR, MATERIALS AND EQUIPMENT NECESSARY FOR THE INSTALLATION OF A COMPLETE ELECTRICAL SYSTEM AS INDICATED WITHIN THESE DRAWINGS. ALL WORK SHALL BE INSTALLED IN STRICT ACCORDANCE WITH ALL APPLICABLE CODES AND ORDINANCES AND WITH MANUFACTURER'S RECOMMENDATIONS.
- 1.2. ALL WORK, MATERIALS AND EQUIPMENT SHALL COMPLY WITH THE NATIONAL ELECTRICAL CODE 2008 EDITION.
- 1.3. THE CONTRACTOR SHALL CAREFULLY EXAMINE THE ARCHITECTURAL, STRUCTURAL, ELECTRICAL AND MECHANICAL DRAWINGS PRIOR TO SUBMITTING HIS BID. THE CONTRACTOR WILL BE REQUIRED TO FURNISH, INSTALL AND CONNECT ALL ITEMS AS INDICATED ON THE DRAWINGS.
- 1.4. THE ARCHITECT SHALL BE NOTIFIED OF ANY CONFLICTS, OR INTERFERENCES THAT OCCUR BETWEEN INDIVIDUAL DRAWINGS.
- 1.5. ALL MATERIALS AND EQUIPMENT SHALL BE INSTALLED IN A NEAT, FIRST CLASS, WORKMANLIKE MANNER, TO THE APPROVAL OF THE ARCHITECT/ENGINEER AND GOVERNING AUTHORITIES.
- 1.6. IN ADDITION TO THE MANUFACTURERS STANDARD GUARANTEES, THE CONTRACTOR SHALL GUARANTEE ALL MATERIALS, EQUIPMENT AND WORKMANSHIP AGAINST DEFECTS FOR ONE YEAR FROM THE DATE OF FINAL ACCEPTANCE, AND SHALL CORRECT ANY DEFECTS AT NO ADDITIONAL COST TO THE OWNER. ALL LAMPS SHALL BE GUARANTEED FOR 30 DAYS AFTER ACCEPTANCE.
- 1.7. THE LOADS SHOWN FOR APPLIANCES AND EQUIPMENT ARE BASED ON DESIGN INFORMATION. THE CONTRACTOR SHALL VERIFY ALL APPLIANCE LOADS PRIOR TO RUNNING THE CIRCUIT. THE MINIMUM CIRCUIT REQUIREMENTS SHALL BE BASED ON THE APPLIANCE NAMEPLATE VALUE OR CODE REQUIREMENTS, WHICHEVER IS MORE STRINGENT. ADDITIONAL COMPENSATION SHALL NOT BE ALLOWED FOR APPLIANCE MODIFICATIONS BY THE CONTRACTOR.
- 1.8. PRIOR APPROVAL: PRIOR APPROVAL SHALL BE REQUIRED FOR ANY MANUFACTURER OTHER THAN THOSE LISTED FOR ALL SPECIFIED ITEMS IN THESE DRAWINGS. SUBMIT ALL REQUESTS FOR PRIOR APPROVAL 2 WEEKS PRIOR TO BID OPENING. ENGINEER'S APPROVAL WILL BE IN THE FORM OF AN ADDENDUM.
- 1.9. APPROVAL SUBMITTALS: PROVIDE 6 COPIES OF APPROVAL SUBMITTALS FOR ALL EQUIPMENT BEING PROVIDED FOR ENGINEERS REVIEW.
- 1.10. O&M MANUALS: PROVIDE 3 COPIES OF OPERATIONS AND MAINTENANCE MANUALS AT THE SUBSTANTIAL COMPLETION INSPECTION.
- 1.11. AS-BUILTS: PROVIDE A MARKED-UP SET OF DRAWINGS FOR AS-BUILTS.

2. CODES & STANDARDS:

- 2.1. INSTALLATION AND MATERIALS SHALL COMPLY WITH THE LATEST EDITION OF THE FOLLOWING CODES & STANDARDS:
  - 2.1.1. NEC
  - 2.1.2. NFPA 72
  - 2.1.3. IBC
  - 2.1.4. IECC
  - 2.1.5. ADA
  - 2.1.6. ANSI
  - 2.1.7. NEMA
  - 2.1.8. OSHA
  - 2.1.9. UL

3. ALTERATIONS & ADDITIONS TO EXISTING WORK:

- 3.1. ALL NECESSARY ADDITIONS AND ALTERATIONS TO EXISTING WORK AS REQUIRED TO PROVIDE AND MAINTAIN A COMPLETE AND PROPER ELECTRICAL INSTALLATION.
- 3.2. AS NECESSARY, RELOCATE EXISTING ELECTRICAL WORK SO OTHER TRADES CAN PURSUE THEIR WORK.
- 3.3. MAINTAIN POWER TO EXISTING PORTIONS OF BUILDINGS FED FROM OR THROUGH AREA IN SCOPE OF THIS CONTRACT.
- 3.4. COORDINATE ALL REQUIRED OUTAGES WITH OWNER.

4. BASIC MATERIALS & METHODS:

- 4.1. ALL POWER AND DISTRIBUTION CABLING SHALL BE COPPER TYPE THWN/THHN.
- 4.2. WALL OUTLETS SHALL NOT BE INSTALLED BACK TO BACK.
- 4.3. ALL ELECTRICAL EQUIPMENT, DEVICES, ETC. LOCATED OUTDOORS SHALL BE WEATHERPROOF.
- 4.4. ELECTRICAL CONTRACTOR SHALL PROVIDE ADEQUATE AND PROPER SUPPORT FOR ALL ELECTRICAL OUTLETS, DEVICES, LIGHT FIXTURES, ETC. BUILT IN OR MOUNTED ON CEILINGS. NO OUTLET BOX, DEVICE, LIGHT FIXTURE, ETC. SHALL BE SUPPORTED FROM ANY ACOUSTICAL CEILING TILE OR DRYWALL CEILINGS. PROVIDE METAL SUPPORTS THAT ARE MADE FOR USE WITH CEILING GRID SYSTEMS OR PROVIDE HANGERS FROM STRUCTURE ABOVE.
- 4.5. CONDUIT ROUTINGS AND DEVICE/EQUIPMENT LOCATIONS SHOWN ARE DIAGRAMMATIC ONLY. CONTRACTOR SHALL FIELD ROUTE AND LOCATE AS REQUIRED. CONDUIT ROUTINGS SHALL BE PARALLEL OR PERPENDICULAR TO BUILDING LINES.
- 4.6. JUNCTION BOXES LOCATED ABOVE CEILING SHALL BE INSTALLED FACING DOWN AND SHALL BE ACCESSIBLE AFTER INSTALLATION.
- 4.7. COORDINATE WITH OTHER TRADES AND STRUCTURE.
- 4.8. THE CONDUIT MATERIAL SHALL BE AS FOLLOWS:
  - 4.8.1. BELOW GRADE - RNC (POWER & SITE LIGHTING ONLY). ELBOWS  $>1\text{'}/2$ " SHALL BE RGS.
  - 4.8.2. RISER FROM 36" BELOW GRADE - RGS.
  - 4.8.3. CONCEALED RISER FROM 36" BELOW GRADE - RNC (POWER ONLY).
  - 4.8.4. ABOVE GRADE SUBJECT TO PHYSICAL ABUSE - RGS.
  - 4.8.5. ABOVE GRADE NOT SUBJECT TO PHYSICAL ABUSE OR WEATHER - EMT.
  - 4.8.6. INDOORS NOT SUBJECT TO PHYSICAL ABUSE - EMT.
  - 4.8.7. ALL INTERCOM, FIRE ALARM, CLOCK AND CCTV CONDUITS INSTALLED BELOW GRADE THAT ARE NOT UNDER THE BUILDING SLAB - RGS.
  - 4.8.8. FINAL CONDUIT CONNECTIONS TO HEAT PUMPS, AIR HANDLERS, EXHAUST FANS, AND WATER HEATERS SHALL BE LFMC WHETHER INTERIOR OR EXTERIOR.
- 4.9. CONDUIT FITTINGS SHALL BE AS FOLLOWS:
  - 4.9.1. EMT -  $<2$ " USE GALVANIZED STEEL COMPRESSION WITH INSULATED THROATS,  $>2$ " USE SET-SCREW STEEL WITH INSULATED THROATS. SET-SCREW COUPLINGS SHALL USE A MINIMUM OF FOUR SCREWS.
  - 4.9.2. RGS - THREADED GALVANIZED STEEL.
  - 4.9.3. PVC - PVC APPROVED FOR THE USE.
  - 4.9.4. FMC - ZINC-PLATED STEEL OR CADMIUM-PLATED MALLEABLE IRON SCREW TYPE WITH INSULATED THROAT.
  - 4.9.5. LFMC - CADMIUM-PLATED MALLEABLE IRON OR STEEL COMPRESSION TYPE WITH INSULATED THROAT.
  - 4.10. ALL OUTLET BOXES SHALL BE 4"X4"X1-1/2" DEEP MINIMUM.
- 4.11. ELECTRICAL CONTRACTOR SHALL WORK CLOSELY WITH THE MASONRY CONTRACTOR ON THE INSTALLATION OF ALL ELECTRICAL BOXES, CABINETS, RINGS, ETC. IN MASONRY WALLS. THE BOXES SHALL BE INSTALLED AT THE UNIFORM HEIGHTS CALLED FOR ON THE DRAWINGS AND SPECIFICATIONS. PROVIDE APPROPRIATE DEPTH MASONRY RINGS FOR ALL OUTLETS IN MASONRY WALLS TO INSURE PROPER CUTTING AND FITTING. THE FACE OF THE CABINETS, BOXES, RINGS, ETC. SHALL BE PLUMB AND FLUSH WITH THE FACE OF THE FINISH MATERIAL. ANY CABINET, OUTLET BOX, ETC. NOT MEETING THE ABOVE REQUIREMENT SHALL BE REMOVED AND REINSTALLED AT NO ADDITIONAL COST TO THE OWNER.
- 4.12. ALL SIDEWALKS AND PARKING LOT ASPHALT AREAS THAT ARE CUT DUE TO NEW ELECTRICAL SERVICES SHALL BE REPAIRED TO MATCH EXISTING.
- 4.13. ALL DIMENSIONS TO DEVICES AFF SHALL BE TO CENTERLINE UNLESS NOTED OTHERWISE.
- 4.14. WALL OUTLETS SHALL NOT BE INSTALLED BACK TO BACK.
- 4.15. COORDINATE LOCATIONS OF ELECTRICAL EQUIPMENT, DEVICES, OUTLETS, FIXTURES, ETC., WITH ARCHITECTURAL PLANS, ELEVATIONS AND REFLECTED CEILING PLANS PRIOR TO ROUGH-IN WORK.

5. GROUNDING & BONDING:

- 5.1. PROVIDE AN INSULATED EQUIPMENT GROUNDING CONDUCTOR IN ALL CONDUITS.
- 5.2. BELOW GRADE CONNECTIONS SHALL BE EXOTHERMIC TYPE.
- 5.3. ALL CABLES SHALL BE COPPER, ALL BOLTED CONNECTIONS SHALL BE BRONZE.

6. IDENTIFICATION:

- 6.1. PROVIDE ENGRAVED 1"X3" PHENOLIC LABELS FOR ALL PANELBOARDS, SAFETY SWITCHES, TRANSFORMERS, CABINETS, ETC.
- 6.2. PAINT THE RACEWAY SYSTEM COUPLINGS AND BOX COVERS ABOVE CEILINGS FOR THE FOLLOWING SYSTEMS AS FOLLOWS:
  - 6.2.2. 208 VOLT SYSTEMS - BLACK.
- 6.3. AFTER PAINTING, WRITE THE CIRCUIT NUMBER (I.E. "1A-34") ON ALL BRANCH CIRCUIT JUNCTION BOX COVERS ABOVE CEILING WITH WHITE MARKER.
- 6.4. PROVIDE UPDATED TYPE WRITTEN DIRECTORIES FOR ALL PANELS MODIFIED DURING THIS RENOVATION.

7. GENERAL WIRING DEVICES:

- 7.1. SWITCHES - SPECIFICATION GRADE, 20 AMP. COLOR BY ARCHITECT.
- 7.2. COVER PLATES - NYLON. COLOR BY ARCHITECT.
- 7.3. APPROVED MANUFACTURERS - HUBBELL, LEVITON, EAGLE, PASS & SEYMOUR.

8. MOTOR STARTERS:

- 8.1. MANUAL TYPE SHALL BE TOGGLE WITH THERMAL OVERLOAD.
- 8.2. MAGNETIC TYPE SHALL HAVE SOLID STATE OVERLOAD RELAY WITH  $\phi$  LOSS AND  $\phi$  UNBALANCE PROTECTION, HOA SWITCH, RED RUN AND GREEN STOP LED LIGHTS.
- 8.3. INTERIOR - NEMA 1.
- 8.4. EXTERIOR - NEMA 3R.
- 8.5. APPROVED MANUFACTURERS - SQUARE D, GENERAL ELECTRIC, CUTLER-HAMMER, SIEMENS.

9. LIGHTING:

- 9.1. PROVIDE SAFETY CHAIN IN ADDITION TO EXISTING SUPPORT FOR NEW GYM LIGHTING. SAFETY SHAIN TO BE SECURED TO STRUCTURE.

2. CONDUIT ROUTINGS AND DEVICE/EQUIPMENT LOCATIONS SHOWN ARE DIAGRAMMATIC ONLY, CONTRACTOR SHALL FIELD ROUTE AND LOCATE AS REQUIRED. CONDUIT ROUTINGS SHALL BE NORTH/SOUTH OR EAST/WEST.

4. FOR OTHER THAN LIGHTING FIXTURES, CATALOG NUMBERS AND MANUFACTURERS SHOWN ARE TO INDICATE DEVICE, QUALITY, AND TYPE OF ITEM DESIRED ONLY. ANY SUBSTITUTION ON THE LIGHTING FIXTURES MUST BE PREAPPROVED TWO WEEKS PRIOR TO BID.

B) RISER FROM 36" BELOW GRADE - RIGID GALVANIZED STEEL.

D) ABOVE GRADE SUBJECT TO PHYSICAL ABUSE - RIGID GALVANIZED STEEL OR INTERMEDIATE.  
E) ABOVE GRADE NOT SUBJECT TO PHYSICAL ABUSE OR WEATHER - ELECTRICAL METALLIC TUBING.  
F) INDOORS NOT SUBJECT TO PHYSICAL ABUSE - ELECTRICAL METALLIC TUBING.  
G) ALL INTERCOM, FIRE ALARM, CLOCK AND CCTV CONDUITS INSTALLED BELOW GRADE THAT ARE NOT UNDER THE BUILDING SLAB - INTERMEDIATE OR RIGID METAL.

6. THE LOADS SHOWN FOR APPLIANCES AND EQUIPMENT ARE BASED ON DESIGN INFORMATION. THE CONTRACTOR SHALL VERIFY ALL APPLIANCE LOADS PRIOR TO RUNNING THE CIRCUIT. THE MINIMUM CIRCUIT REQUIREMENTS SHALL BE BASED ON THE APPLIANCE NAMEPLATE VALUE OR CODE REQUIREMENTS, WHICHEVER IS MORE STRINGENT. ADDITIONAL COMPENSATION SHALL NOT BE ALLOWED FOR APPLIANCE MODIFICATIONS BY THE CONTRACTOR.

7. COORDINATE LOCATIONS OF ELECTRICAL EQUIPMENT, DEVICES, OUTLETS, FIXTURES, ETC., WITH ARCHITECTURAL PLANS, ELEVATIONS AND REFLECTED CEILING PLANS PRIOR TO ROUGH-IN WORK.

8. WALL OUTLETS SHALL NOT BE INSTALLED BACK TO BACK.

9. CONTRACTOR SHALL SUPPLY ALL NECESSARY ELECTRICAL DEVICES IN THE CABINETS, INCLUDING BUT NOT LIMITED TO: RECEPTACLES; CONDUIT; JUNCTION BOXES; CONDUCTORS, DEVICE PLATES.

10. PROVIDE A 6'-0" MAXIMUM FLEXIBLE CONNECTION FROM EACH RECESSED LIGHTING FIXTURE TO JUNCTION BOX ABOVE CEILING

11. VERIFY FLOOR RECEPTACLE LOCATIONS WITH ARCHITECT PRIOR TO ROUGH-IN.

12. ALL FIRE ALARM CIRCUITS SHALL BE TERMINATED ON TERMINAL STRIPS. WIRE NUTS ARE PROHIBITED. ALL ANNUNCIATING AND INITIATING CIRCUITS ENTERING THE BUILDING AND AT THE FIRE ALARM PANEL SHALL BE PROVIDED WITH SUITABLE SURGE SUPPRESSORS (SEE SPECIFICATIONS).

13. VERIFY ALL POWER/DATA/PHONE RECEPTACLE ELEVATIONS LOCATED 7" CENTER LINE OVER COUNTERTOP WITH ARCHITECTURAL DETAILS. PRIOR TO ROUGH-IN. LOCATE LONG AXIS HORIZONTALLY.

14. ALL CONDUITS NOT LOCATED UNDER SLAB SHALL HAVE A MINIMUM BURIAL DEPTH OF 36" UNLESS NOTED OTHERWISE

15. ALL SAFETY SWITCH DISCONNECTS LOCATIONS IN MECHANICAL ROOMS SHALL HAVE 3'-0" MIN. OF WORKING SPACE IN FRONT OF DISCONNECT; COORDINATE WITH MECHANICAL CONTRACTOR AND EQUIPMENT LOCATIONS.

16. FINAL CONDUIT CONNECTIONS TO HEAT PUMPS, AIR HANDLERS, EXHAUST FANS, AND WATER HEATERS SHALL BE FLEXIBLE METAL (LIQUID TIGHT IN FLAMMABLE, OUTSIDE AND OTHER DAMP AND WET LOCATIONS).

17. CONTRACTOR SHALL COORDINATE ALL WORK WITH OTHER TRADES PRIOR TO INSTALLATION. REFER TO MECHANICAL AND PLUMBING DRAWINGS FOR EXACT LOCATION AND SIZE OF EQUIPMENT WHICH ARE PROVIDED BY OTHERS AND CONNECTED BY ELECTRICAL.

18. RECEPTACLES, SWITCHES COLOR SHALL BE SELECTED BY THE ARCHITECT FROM STANDARD COLORS. ALL COVER PLATES SHALL BE 302 STAINLESS STEEL.

19. VERIFY ALL DOOR SWINGS WITH ARCHITECTURAL DRAWINGS PRIOR TO ROUGHING IN FOR SWITCHES.

20. CONDUITS LEAVING OR ENTERING BUILDING SHALL BE SEALED PER N.E.C. TO PREVENT ENTRANCE OF MOISTURE.

21. ALL EXHAUST FAN DISCONNECTS AND OVERLOADS ARE SCHEDULED TO BE PROVIDED UNDER DIVISION 15.

22. ALL DIMENSIONS TO DEVICES AFF SHALL BE TO CENTERLINE UNLESS NOTED OTHERWISE.

23. WORKING SPACE OF 36" FOR 120/208 SYSTEMS AND 42" FOR 277/480 SYSTEMS SHALL BE MAINTAINED IN FRONT OF ALL ELECTRICAL PANELS AND DEVICES.

24. ALL SIDEWALKS AND PARKING LOT ASPHALT AREAS THAT ARE CUT DUE TO NEW ELECTRICAL SERVICES SHALL BE REPAIRED TO MATCH EXISTING.

25. FINAL CONNECTION TO ALL EQUIPMENT IS SHOWN DIAGRAMMATIC. PROVIDE FINAL CONNECTION AS REQUIRED PER MANUFACTURER OF EQUIPMENT.





- ## GENERAL NOTES

1. UNLESS OTHERWISE NOTED, ALL EXISTING GYM AND EXTERIOR LIGHTING FIXTURES AND ASSOCIATED CONTROLS IN THE AREA OF WORK ARE TO BE REMOVED AND REPLACED NEW PER NEW PLANS. EXISTING CIRCUITS ARE TO BE SECURED AND REUSED FOR NEW WORK PROTECT DURING DEMOLITION.
2. THE ELECTRICAL CONTRACTOR SHALL VERIFY FINAL QUANTITY AND FINAL LOCATION OF ALL DEVICES AND FIXTURES PRIOR TO BEGINNING ANY WORK.
3. THE ELECTRICAL CONTRACTOR SHALL ENSURE THAT ALL FIXTURES / CIRCUITS BEYOND THE SCOPE OF WORK THAT ARE TIED INTO THE CIRCUITS WITHIN THE SCOPE OF WORK ARE OPERABLE DURING THE RENOVATION AND FULLY FUNCTIONAL UPON COMPLETION OF THE PROJECT.

**COMMUNITY CENTER  
LIGHTING PLAN -  
DEMOLITION**

## HOPE COMMUNITY CENTER IMPROVEMENTS

2400 5th Avenue South, Suite 200  
Birmingham, AL 35233  
T 205.879.4462  
GMCNETWORK.COM

A circular professional engineer seal for the state of Alabama. The outer ring contains the text "ALABAMA" at the top and "ENGINEER" at the bottom, separated by two stars. Inside the ring, the word "LICENSED" is at the top and "PROFESSIONAL" is at the bottom. In the center, the name "Christina Marie" is written in blue cursive, and the license number "No. 50660" is printed below it. At the bottom of the seal, the date "04/12/2003" is handwritten in blue ink.

ר.ע.ר.

sheet c

	ISSUE	DATE
	ISSUED FOR BID SET	04/12/2023
1	ADDENDUM #2	2023-05-02
	DRAWN BY:	CM
	CHECKED BY:	CM



	ISSUE	DATE
	ISSUED FOR BID SET	04/12/2023
1	ADDENDUM #2	2023-05-02
	DRAWN BY:	CM
	CHECKED BY:	CM

850 EDWARDS STREET  
MOBILE ALABAMA 36610

# C-E2.11

sheet of



## GENERAL NOTES

1. UNLESS OTHERWISE NOTED, ALL EXISTING GYM AND EXTERIOR LIGHTING FIXTURES AND ASSOCIATED CONTROLS IN THE AREA OF WORK ARE TO BE REMOVED AND REPLACED NEW PER NEW PLANS. EXISTING CIRCUITS ARE TO BE SECURED AND REUSED FOR NEW WORK PROTECT DURING DEMOLITION.
2. THE ELECTRICAL CONTRACTOR SHALL VERIFY FINAL QUANTITY AND FINAL LOCATION OF ALL DEVICES AND FIXTURES PRIOR TO BEGINNING ANY WORK.
3. THE ELECTRICAL CONTRACTOR SHALL ENSURE THAT ALL FIXTURES / CIRCUITS BEYOND THE SCOPE OF WORK THAT ARE TIED INTO THE CIRCUITS WITHIN THE SCOPE OF WORK ARE OPERABLE DURING THE RENOVATION AND FULLY FUNCTIONAL UPON COMPLETION OF THE PROJECT.



# Interior Lighting Compliance Certificate

## Project Information

Energy Code: 2015 IECC  
Project Title: HOPE COMMUNITY CENTER GYM  
Project Type: Alteration

Construction Site:  
850 EDWARDS STREET  
MOBILE, Alabama 36610

Owner/Agent:

Designer/Contractor:

## Allowed Interior Lighting Power

A Area Category	B Floor Area (ft <sup>2</sup> )	C Allowed Watts / ft <sup>2</sup>	D Allowed Watts
1-COMMUNITY CENTER (Gymnasium)	8033	0.94	7551
Total Allowed Watts =			7551

## Proposed Interior Lighting Power

A Fixture ID : Description / Lamp / Wattage Per Lamp / Ballast	B Lamps/ Fixture	C # of Fixture	D Fixture Watt.	E (C X D)
COMMUNITY CENTER (Gymnasium, 8033 sq.ft.) LED: HB: Other:	1	24	178	4272
Total Proposed Watts =				4272

## Interior Lighting PASSES

### Interior Lighting Compliance Statement

*Compliance Statement:* The proposed interior lighting alteration project represented in this document is consistent with the building plans, specifications, and other calculations submitted with this permit application. The proposed interior lighting systems have been designed to meet the 2015 IECC requirements in COMcheck Version COMcheckWeb and to comply with any applicable mandatory requirements listed in the Inspection Checklist.

Christina Marie - Professional Engineer

Name - Title

Signature

05/02/2023

Date





# Exterior Lighting Compliance Certificate

## Project Information

Energy Code: 2015 IECC  
Project Title: HOPE COMMUNITY CENTER GYM  
Project Type: Alteration  
Exterior Lighting Zone: 3 (Other (LZ3))

Construction Site:  
850 EDWARDS STREET  
MOBILE, Alabama 36610

Owner/Agent:

Designer/Contractor:

## Allowed Exterior Lighting Power

A Area/Surface Category	B Quantity	C Allowed Watts /	D Tradable Wattage	E Allowed Watts (B X C)
Entry canopy	458 ft2	0.4	Yes	183
Other door (not main entry)	15 ft of	20	Yes	300
Illuminated area of facade wall or surface	660 ft2	0.15	No	99
Total Tradable Watts (a) =				483
Total Allowed Watts =				582
Total Allowed Supplemental Watts (b) =				750

(a) Wattage tradeoffs are only allowed between tradable areas/surfaces.

(b) A supplemental allowance equal to 750 watts may be applied toward compliance of both non-tradable and tradable areas/surfaces.

## Proposed Exterior Lighting Power

A Fixture ID : Description / Lamp / Wattage Per Lamp / Ballast	B Lamps/ Fixture	C # of Fixture	D Fixture Watt.	E (C X D)
<u>Entry canopy (458 ft2): Tradable Wattage</u>				
LED: EVO: Other:	1	3	32	95
LED: ST: Other:	1	3	48	144
<u>Other door (not main entry) (15 ft of door width): Tradable Wattage</u>				
LED: WPX: Other:	1	4	24	96
<u>Illuminated area of facade wall or surface (660 ft2): Non-tradable Wattage</u>				
LED: WPX: Other:	1	5	24	120
Total Tradable Proposed Watts =				335

## Exterior Lighting PASSES

### Exterior Lighting Compliance Statement

*Compliance Statement:* The proposed exterior lighting alteration project represented in this document is consistent with the building plans, specifications, and other calculations submitted with this permit application. The proposed exterior lighting systems have been designed to meet the 2015 IECC requirements in COMcheck Version COMcheckWeb and to comply with any applicable mandatory requirements listed in the Inspection Checklist.

Christina Marie - Professional Engineer

Name - Title

Signature

05/02/2023

Date

Project Title: HOPE COMMUNITY CENTER GYM

Data filename:

Report date: 04/30/23

